

# EAST MONTPELIER Signpost

Volume 3, No. 2

November/December 1992

## PROFILE OF A NATIVE VERMONTER

Folks around these parts know Bradford Lane well, as a neighbor, farmer and lister. I had the pleasure recently to sit down with Bradford and his wife Ruth in their comfortable cottage off the County Road to chat about the Lane family history. Like a sage Bradford began to reminisce about the "good ol' days," realizing that "there is an awful fine line between a fact and what you imagine."

For nearly 150 years the Lane family has made central Vermont their home. Bradford's great grandfather, Culver, first moved to the Gould Hill section of Montpelier in 1832, when he purchased a house, barn and 70 acres of land for \$500. The next two generations of Lanes were born and raised here, carrying on the tradition of dairy farming.

Bradford's father Homer ventured on his own in 1915 when he started a dairy operation in Horn of the Moon. When his father passed away in 1938, Bradford took over the 275 acre farm at the age of 21. A pretty, young school teacher soon caught his eye, and in 1940 Bradford and Ruth Lamson were married. The couple had three children, Clair, David and Stanley. For 46 years, Bradford milked a herd of registered Holsteins, in addition to logging and sugaring during the winter months. None of the children were interested in carrying on the tradition of farming, one of them for the obvious reason that he was allergic to cows. So in 1986 Bradford and Ruth retired from farming and moved to their present home on the County Road.



Bradford Lane

Throughout the years, Bradford always found time to be involved in community affairs. He is a former chairman of the town committee and member of the school study committee, and has served on several agricultural committees, including the

Vermont  
Artificial Breeders  
Association.

East Montpelier residents probably remember Bradford most as a town lister. For 24 years, he appraised homes and farms in the area. When he began listing in 1959, a \$3,000 base value for a good home was common, regardless of location in town.

As a part-time lister for the town myself, I had the pleasure of working with Bradford on numerous occasions. He was always extremely conscientious in coming up with a fair appraisal. He enjoyed his work, particularly because of the opportunity it gave him to meet people; Bradford loved to talk. Once when we were inspecting a new farm building Bradford said that our guidelines from the State never anticipated such a structure and this one "ran right off the pages." In a lister's job, you can't please everybody all the time. Bradford recalls with a chuckle that one time, at a country fair, he overheard someone say he "could never die of a heart attack because he had no heart." Obviously the comment came from someone who didn't think his house was worth as much as Bradford thought. According to Bradford, "90% of the people who grieve an appeal have no real cause, but do so out of habit." At one grievance hearing, he said a resident was so bold as to say he wanted "to talk to someone who knew what they were doing."

Like most people his age, the years of experience and knowledge have made Bradford very opinionated. During our talk, he was very critical about politics, local control and a federally funded health care system.

Bradford now spends his leisure time between Florida and Vermont. Asked which area he prefers, he says he loves Vermont, but Florida is cheaper, less restrictive in regulations, and has excellent weather with the exception of occasional storms, but those can happen in New England too. Florida has the seashore, with its sand and shells, he added.

Bradford's hobbies include flower gardening and stamp collecting, in addition to being a great conversationalist.



Bradford and Ruth are a unique couple, true Vermonters, who have made a number of special contributions to neighbors and community, a gift that seems a rarity in our time. It has certainly been a pleasure knowing and working with him, and I'm glad for the opportunity to tell you briefly about him.

Dean Shattuck

**FROM THE TOP OF THE SIGNPOST**

*Take back the system! That is the watchword of the League of Women Voters, an organization for which I have great respect. This year especially I have thought about what this motto means. More than in any election year past, Americans have tuned out the system either in disgust over the choices available to them or feeling helpless that their vote will count. The urge to "throw the bums out" has brought out an army of new candidates who are asking us to put them in office to straighten things out. How do we know that government will be better served - at any level from East Montpelier to Washington - by the newcomers? We don't, of course, but there was never a better time to find out what each candidate stands for, whether that person has served for 20 years or never. Lucky for us, candidates here in Vermont are always available to us. Talk with them. Ask questions. Then vote on November 3.*

*For me, "take back the system" means that our democracy will only work if we participate in the most basic part of American government by voting and knowing who we are voting for.*

Jean Cate

*P.S. I heard from Sylvia that 63 names were added to the check list before the primary and 159 since, for a total of 222 names!*



THE COTTAGE SHOP ANNOUNCES

"SPECIAL HOLIDAY HOURS"

YARNS & CRAFTS AVAILABLE

Beginning December 9, 1992 Wed.-Fri. 2:00-7:00 P.M.  
Sat. 10:00 A.M.-2:00 P.M. Anytime by Appointment

223-6607 or 229-9896 Quaker Road  
East Montpelier

Handcrafts by: Donna, Linda and Ann

**THANK YOU ALL FOR 'RALLYING' AROUND THE SIGNPOST!**

The Signpost is most grateful to everyone who helped raise over \$1,350 through the auction on Rally Day. Many people were involved, from the hard working committee (Doug Kievit-Kylar, chair, David Connor, Nancy Couch, Betsy Morse, and Jean Vissering) to all the donors of services and items:

- |                                 |                         |
|---------------------------------|-------------------------|
| Abbie's Place                   | Annis Acres Farm        |
| Joyce Bean                      | Ben & Jerry's           |
| Blosser Ins. Agency             | Karen Blosser           |
| Bragg Farm Sugar House          | Capital Market          |
| Capitol Video                   | Tim Carver              |
| Paul & Sandal Cate              | Wes & Jean Cate         |
| Bruce & Janet Chapell           | The Country Store       |
| The Drawing Board               | Nona Estrin             |
| Jim Goodall                     | Hawkins Landcare Servs. |
| Ellen Hill & Lynn Blackwell     | Hill's Repair           |
| Jan's Beauty Boutique           | Jonathan & Ellie Lash   |
| Loso Vacuum Cleaner Service     | Morse Farm              |
| Marian Palmer                   | Kelly Phillips          |
| Philura's Restaurant            | Robin's Peach Tree      |
| Deedee Robinson                 | Steve's Market          |
| Mary Stone                      | T & M Motor Sports      |
| Thistle Hill Pottery            | Utton's Muffler         |
| Vt. Northern Lights Art Classes | Jean Vissering          |
| Washington Electric Coop        | Wedgewood               |
| Wintergreen Nursery             | Brad & Carroll Witham   |

**AND A SPECIAL THANK YOU FOR OUR CONTINUING SUPPORTERS!**

- |                        |                            |
|------------------------|----------------------------|
| Marion Codling         | David Connor & Ann Stanton |
| Jeffrey & Linda Cueto  | Ernest & Estelle Dodge     |
| Gladys Dunkling        | Bernard & Marcia Guilmette |
| Richard & Esther Hill  | Bradford & Ruth Lane       |
| George & Minnie Lane   | James & Alice Murphy       |
| Samuel & Barbara Starr | Frederick & Nancy Strong   |

**THE POLLS ARE OPEN  
ON NOVEMBER 3  
FROM 7 A.M TO 7 P.M.  
AT THE ELEMENTARY SCHOOL.  
BE SURE TO VOTE!**

**AND DON'T FORGET PROPERTY  
TAXES ARE DUE BY TUESDAY,  
NOVEMBER 10.**

Deadline for the next issue is December 1.  
Please get copy to Janice Waterman,  
RR 1, Box 4330, Montpelier, VT 05602, 223-5826.

## WASHINGTON ELECTRIC: LIGHTING THE COOP WAY

*This article takes a different format from our usual business profiles as author Stuart Friedman (SF) talks to Washington Electric Coop's Manager Joe Bongiovanni (JB).*

*SF: The business of selling electricity has changed dramatically over the years. How has that affected the Coop in particular?*

JB: When electricity coops started, they were trying to bring comfort and convenience to the farms of the area. We would go to the farm site and bring in new technologies, improve the capabilities both in the home and on the farm. That was the unique relationship of the coop, going out and showing people how electricity could improve their lives. The change that has taken place is that with electricity getting more expensive, the expansion of demand was causing negative economic consequences. So now we are slowing the growth of the utility. In both instances our goal has been to improve the economics of the customer. How you do that is what has changed.

*SF: What are some of your efforts in slowing the growth of the utility?*

JB: Electricity is an especially useful energy source. We need to preserve electricity for those services that make the best use of it. What we are doing is reminding ourselves that we are an 8200-member-owned utility, and we are using the business to benefit the people who own it. All of our demand side management efforts are driven by the fact that the cost of electricity will continue to increase.

There is a general consensus that we are going to live with supplies that are available to us; nothing holds great prospect for large increases in cheap power sources. By helping our customers use less electricity we can purchase power for them at lower cost than purchasing new capacity. By the year 2000 we anticipate annual savings to our customers of \$1.6 million.

For our moderate use members we will audit all their energy uses and oversee the installation of water conservation and lighting efficiency measures. The customer saves and we save. We are also sponsoring a mail order light bulb program, making high efficiency light bulbs available to members with a 50-60% subsidy.

Our high users will also be reviewed for possible fuel switching, where we would pay for installing a new heating system, for example, with the customer paying the coop half the savings for five years. Again, we save money and the customer saves money.

*SF: There also seems to be a positive local economic impact for such a program:*

JB: Correct, rather than send the money out of state to purchase electricity we are using our membership's resources to purchase the work of local contractors who would do the fuel switching work.

*SF: I understand that the coop is looking at playing a larger role in economic development efforts.*

JB: At the next meeting of the Board we will be discussing ways of gaining access to additional funds for economic development. We are open to any kind of activity that is acceptable to the community. And it is important to state that we are firmly committed to work with the Central Vermont Economic Development Corporation. These are funds that are available for us to lend to local projects, projects that would be both economically and environmentally sound.



*Joe Bongiovanni at the Coop*

*SF: Given the economic situation that can't help but be welcomed. Has the Coop any current plans on moving its office?*

JB: We are no longer seeking to sell our office building. Efforts to sell have been put aside, and we are now working on some renovations, taking what started as a garage warehouse and making it more efficient. We will also be getting rid of our electric heat, even though we pay less for the electricity than do our customers. We want to do what we are helping our members do.

*SF: What sort of contribution does the Coop itself make to the economic activity in the area?*

JB: We are an important player in East Montpelier. We have 600 members here in town, and we employ 40 people and have an annual payroll of about \$1 million. We generate about \$6.5 million in revenues each year, own \$25 million in plant, and pay East Montpelier \$35,000 in property taxes. And I have to add, it is a real pleasure for me to work in East Montpelier after years of long commutes.

*Stuart Friedman*

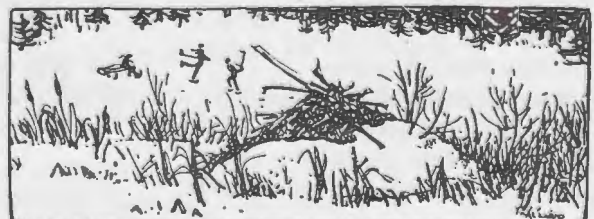



**THE SELECT BOARD**

*Weston Cate, Allan Couch, Edie Miller*

**July 8, 1992**

\* Agreed to put school bus stop sign on County Road just north of Hanna driveway at the recommendation of the busing company.

\* Voted to accept proposal of Hall/Cleaves farm expansion and granted approval as one of the four grantees of the development rights.

\* Approved rabies immunization shots for Constable Dennis Carver at a cost of \$270.

**July 22, 1992**

\* Voted to accept the tax stabilization plan and grant approval for five-year contract to Larry and Diane Brown for expansion of printing business.

\* Voted to reappoint Dennis Carver to Conservation Committee through June 1, 1995 and to appoint Wayne Hamilton to the same board through June 1, 1994.

\* Voted to award culvert replacement project on Sanders Circle to Dubois Construction.

\* Approved request from David Blosser to accept fill material from Towne Hill project at his new residence on Towne Hill Road.

**August 19, 1992**

\* Awarded bid for winter sand to Walmer Transportation for delivery from McCullough pit.

\* Received notice of Four Corners School Association vote to indicate town's interest in being second in line after school board in the event reversion of title should occur.

\* Heard Sewage Officer report. Denied application to Real Ouimet (for the former Campbell property on Lyle Young Road) until proper septic system is constructed.

\* Reviewed draft policies of the Conservation Fund Advisory Committee. Questioned whether the fund should be used as a revolving loan fund.

**September 9, 1992**

\* Approved purchase of a new answering machine for town garage.

\* Amended purchasing policy of Road Department to set \$100 limit instead of \$25 limit for purchases not needing preapprovals.

\* Denied request for Lloyd Eldred, Jr. for the replacement of a tire caused by new gravel on road.

\* Heard report from Don Rowan of the Central Vermont Economic Development Corporation. Area unemployment is currently at 3,800, the highest level since 1973.

\* Denied Earth Construction's request to remove 15,000 yards of material from their gravel pit for projects in Bethel/Randolph area pending BOA decision on permit status of gravel pit.

\* Received letter of resignation from James Brock from the Zoning Board of Adjustment.

\* Heard appeal from Real Ouimet on denial of application for sewage permit. After lengthy discussion with Ouimet's lawyer and engineer, voted to sustain decision of the Sewage Officer in denying permit.

\* Agreed to send a letter to the Agency of Transportation emphasizing the importance to the Town that Towne Hill Road have at least one course of pavement in place prior to winter.

\* Discussed concern over the recent closure order received from the Agency of Natural Resources for C.V. Landfill. Selectman Cate will draft a letter to the Acting Secretary of the Agency expressing Town's concern.

**PLANNING COMMISSION**

*Chair: Johanna DeMarino*

**August 6, 1992**

\* Reviewed and approved 3-lot subdivision plan for Fairs on Fair Road.

\* Voted to deny Merritt sign application because the setback requirement was not met.

**August 20, 1992**

\* Approved the site plan review submitted by Willis Backus for a wholesale-retail jewelry enterprise.

\* Roger Chapell reported that Sandy Pines Trailer Park passed annual inspection for conformance to Zoning Regulations.

**September 3, 1992**

\* Discussed Fair Road subdivision. After lengthy discussion determined that there was confusion over which zone the land was in. Recessed review pending further information.

\* Agreed that public hearing was needed to transfer 6/10 acre of land from Ann Stone to Malcolm and Diana Fielder since the land has been involved with a previous subdivision.

**September 17, 1992**

\* Approved preliminary sketch plan for the application for permit by Tim and Anne Carver for 9-lot subdivision on Casavant Road.

\* Approved site plan submitted by Richard Blake for used car lot on Route 14 provided additional trees are planted along the northern boundary and that security lighting be shielded so as not to create an undue nuisance for surrounding residents.



## **BOARD OF ADJUSTMENT**

*Chair: Earle Ellingwood*

### **August 10, 1992**

\* Reviewed Parker application for construction of a new garage requiring a variance for setback requirements. Voted to grant variance with condition that garage be no closer than 44' from the road.

\* Continuation of Earth Construction hearing. Lengthy testimony from their attorney and interested parties. Voted to go into deliberative session.

### **August 24, 1992**

\* Voted to grant a variance to Michael and Tina Machno to construct an addition to their home on Route 14.

\* Lengthy debate on application for building construction for the L. Brown printing business on Route 14. Went into deliberative session. Hearing to be continued.

### **August 31, 1992**

\* Voted that the Earth Construction gravel pit was not a grandfathered operation.

\* Received letter of resignation from James Brock, effective August 31.

---

## **EAST MONTPELIER ELEMENTARY SCHOOL BOARD**

*Jan Aldrich, Sue Stephen, Rich Davidian,  
Tony Klein, Burr Morse*

### **August 12, 1992**

\* Voted to increase price of school lunch, milk and juice due to rising expenses.

\* Voted to adopt new bus discipline procedures.

\* Denied request to use school building for a wedding reception.

### **September 3, 1992**

\* Principal Laura Johnson reported there are 247 students enrolled for 1992-1993 school year and one homeschool child.

\* Decided that for-profit groups using the school building would be charged \$25.00 per session.

\* Green Mountain Chipping will supply wood chips for the year.

### **September 22, 1992**

\* Special meeting to determine whether or not a second bus should be added to the kindergarten route. Children are on the bus one hour and 25 minutes. Lengthy discussion over possibility of three full days for kindergarten to help resolve busing problem. This would require Town vote to change from every day schedule. Laura Johnson and the kindergarten teachers will work on developing a proposal that includes full-day classes for another year. Will try some full-day classes this year to see how it works for the children.

\* Voted to add a second bus route at noon this year.

---

## **CONSERVATION FUND ADVISORY COMMITTEE**

There is currently \$43,000 available to be used for land conservation by the residents of East Montpelier. If you are interested or would like more information regarding this fund, please call one of the committee members: Dennis Carver, Sue Chickering, Wayne Hamilton, Charles Johnson, Brian Lusignan, and Georgiana Miranda.

---

## **FIRE DEPARTMENT**

The Fire Dept. and Fast Squad presented the auto extrication demonstration at Rally Day and hopefully people's questions were answered, but if you have more questions or would like a tour, stop by the station.

Several members are presently involved in emergency care attendant and emergency medical technical training involving over 100 hours per course. A half dozen members will be attending Firefighter I class later this fall, while others will be taking advanced firefighter classes. This is in addition to attending meetings, drills, and functions.

During a recent drill, a new method of fire fighting was demonstrated. This

new method involves the use of Class A Foam that allows fires to be put out faster and decreases the amount of water utilized. Used in the western states to fight forest fires, Class A Foam has just been adapted to use in structural fires and has proven itself effective. Equipment needs to be purchased and installed to use this new technique, and fund raising continues to do this.

October 4 - 10 was Fire Prevention Week with the theme "Test Your Detector, It's Sound Advice." Members visited the East Montpelier and Calais Elementary Schools to present this fire prevention message. **Take the time to check the battery in your smoke detector and maybe a quick vacuuming might be in order.** Remember, like any other tool it does need some maintenance and the time you spend now could save a life later.

Several members of the EMFD and Auxiliary traveled to the National Fire Academy in Emmetsburg, Maryland, on October 11 and attended a memorial service to honor the late First Assistant Chief Robert L. Parker and the other firefighters who died in the line of duty in 1991. Attending were Cooleen and Todd Parker, Chief and Mrs. Michael Garand, Second Assistant Chief and Mrs. Elliott Morse and Captain and Mrs. William George. A memorial service and dedication were also held at the East Montpelier Fire Station on October 6.

---

## **FOUR CORNERS SCHOOLHOUSE ASSOCIATION** *President: Don Donnelly*

At our September meeting, plans were made to hire a carpenter to complete the rest room so the plumbing fixtures can be installed. We continue to send grant applications for the other capital improvements, of which the heating system is a priority.

All sustaining membership donations are being used for operational expenses. We are working on a yearly budget for operations.

The annual Halloween Party will be held at the schoolhouse; it will be held on Saturday, October 31st. Ginny Burley can be contacted for details.



# MOOSE LIPS



◆ *Are we eating crow? You bet! It is humbling to make small mistakes, but ours was a whopper. Forgive us for mixing up the page order in the Town Government insert of the last issue, thus spoiling Janet's cover drawing and making it hard to find where the articles began and ended. We've now reprinted enough copies for the town office and the schools, and you may pick up a proper copy if you wish.*

◆ *The Elementary School ELF Plus Culture program is studying the Mayan in Guatamala, the Kuni in Pamana, and the Abenaki here in Vermont. Representatives will visit the school and the community is invited to participate. The first visitor, a Mayan, will be here from November 18-20. To learn more, call Carolyn Shapiro at 229-5676.*

◆ *Peter and Fran Weinbaum opened their home to an 8-member family from Somalia this summer. The family has now emigrated to Canada.*

◆ *Note that our artist Janet MacLeod and Spike Holden were married on September 21, 1992, at the waterfall in Adamant. One of those run-of-the-mill things to do, casually announced to the Holden family as part of the other errands done that day. They live in Harvard, MA.*

◆ *The Elementary School's L.E.A.P (Learning Enrichment Activities Program) is looking for volunteers for Friday afternoons, January 8 through February 5, 1:30 - 3:00, to help with Mini Courses. You don't need to be an expert. Bring your interest and enthusiasm! Courses range from cooking to skating to embryology to pottery and much more. For more information call Ellen Knoedler at 223-6931.*

◆ *Sometimes you just shouldn't push it as Hamilton Throckmorton found to his dismay on October 1. Stopping for his mail at the Post Office meant parking in an obvious place and bad luck when a passing trooper noticed an expired inspection sticker.*

◆ *For women and men with laughter and energy, there is volleyball at the Elementary School on Tuesday nights from 7-9.*

◆ *We've had calls from people in Calais and Cabot wanting to know how we got the Signpost going. We hope they find the support and spirit that we have.*

◆ *We heard from former Signpost editor Fred Tubbs recently. He, Kathleen and Erin have settled into Hartland where he has lots of work to do on their "new" old house. We wish them well.*

◆ *Good to hear that Harry Morse is recovering from a stroke. He's been in the Rehab unit in Burlington.*

## MILESTONES

*(Received by the Town Clerk by October 1)*

### BIRTHS

♥ *Alice Curchin born June 3, 1992, to Sarah Kinter & Thomas Curchin.*

♥ *Samuel Charles Jensen born August 5, 1992, to Christine & Charles Jensen.*

♥ *Marisa Jean Mullins born August 14, 1992, to Jeri-Anne & Francis Mullins, III.*

### MARRIAGES

♥ *Robert J. Garrity and Hilary C. Frost on July 25, 1992.*

♥ *Michael B. Cote and Anita K. Bullis, July 25, 1992.*

♥ *Allen J. Lawson and Deborah Ann Hooper, August 1, 1992.*

♥ *Brent A. Healey and Gina Marie Ceppetelli, August 8, 1992.*

♥ *Loren G. Boardman and Linda Lee Schneider, August 15, 1992.*

♥ *Todd H. Fitch and Barbara Bull, August 29, 1992.*

♥ *Glenn M. Tarullo and Martha M. Broad, August 29, 1992.*

♥ *Patrick P. Clark and Kathryn S. McBride, September 5, 1992.*

♥ *John C. Holden and Janet P. MacLeod, September 21, 1992.*

### PASSINGS

*Homer Slayton died August 16, 1992. He was Sylvia Franks' father and lived on the Horn of the Moon Road.*

*Laura Parker died August 31, 1992. She lived in North Montpelier and was Gladys Dunkling's sister.*

## LAND TRANSFERS

*(Received between July 6 and October 1)*

*1.58 acres and mobile home on U.S. Route 2 from Norman & Carla Messier to Kenneth M. Willey.*

*147.6 acres, house and barn on Snow Hill Road from Richard & Bonnie Hall to Seth B. Gardner.*

*1 acre with mobile home on Lyle Young Road from Betty and Eugene Sholan to Real Ouimet.*

*16 acres on Bliss Road from Alice W. Martin to Frederick & Sally Martin.*

*2.3 acres with house on Carlton Boulevard from Richard & Valerie Lewis to Richard & Dixie Blake.*

*4.5 acres with house on Hagggett Road from Gregory Carriveau to Anne Ferguson.*

*34 acres on Sparrow Road from John & Donna Hall to Richard & Bonnie Hall.*

*34 acres on Sparrow Road from Richard & Bonnie Hall to Jeffrey & Charlotte Green.*

*10 acres with mobile home on Gould Hill Road from Bradley DiSalvo to Valerie Stark.*

*Easement off Route 14 in the Village from Richard & Lorraine Copping to Lawrence & Sandra Loso, Jr.*

*1.4 acres with junkyard and barn off U.S. Route 2 in the Village from David Gauthier to Arthur Montague.*

*10 acres on Towne Hill Road from Jan & Glenda Otto to Roger Weingarten & Ellen Lesser.*

*3.2 acres with mobile home on Route 14 from Richard Jr. & Rose McAllister to David & Susan Devine.*

*2.7 acres with house on Upper North Street from Louis & Ann Penn to Elizabeth, Paul & Mary Ann Parker.*

*4 acres with house and barn on County Road from David & Karen Blosser to Richmond & Ginger Hopkins.*



## THE NEW TOWN PLAN

Although some Vermonters look upon planning and zoning as infringements on what they view as their individual rights, the need for land use planning has been recognized since the earliest settlements. Land was a measure of personal and community wealth in 17th century New England and as such was to be carefully planned and utilized.

In 1692 the Massachusetts Bay Colony passed a law prohibiting "nuisance" or "noxious" industries from doing business in any district not specifically designated for that use by a committee of elected officials composed of selectmen and justices of the peace.

These concepts echo throughout Vermont law. Article 2, Chapter I of the Vermont Constitution provides "(T)hat private property ought to be subservient to public uses when necessity requires it, nevertheless, whenever any person's property is taken for the use of the public, the owner ought to receive an equivalent in money." The first modern laws related to planning in Vermont were passed in 1921 and the State Planning Board was created in 1934.

The Vermont Municipal & Regional Planning and Development Act was passed in 1967. It has been amended numerous times since then with the most significant changes being made by Act 200 in 1988. This is the law which enables the town to develop plans and adopt bylaws, the intent of which are to promote the general public health and welfare. The law provides for the formation of the Planning Commission and Zoning Board of Adjustment and sets out specific steps that must be followed in the preparation and adoption of the plan and bylaws.

East Montpelier's town plan, adopted in 1986, has expired under the state law which requires that towns have up-to-date plans every five years. Seeing this deadline ahead, the Planning Commission has involved townspeople over the last several years in designing a new plan to reflect their goals for the future. That plan has now been drafted, reviewed by the Planning Commission and interested individuals, and will be edited by the end of October. The Planning Commission expects to schedule a formal public hearing this fall to solicit further public comments, after which the plan will be officially submitted to the Select Board. The statutes direct them to hold one or more public hearings before they vote to approve or reject the plan.

What does it mean to have a new Town Plan for East Montpelier? The plan itself does not change our lives, but it serves as a foundation for the steps that follow. For instance, our zoning ordinances are based on our plan or design for the town, so any changes can only follow a current Plan. The Plan also serves as an Act 250 reference point so no development can take place that conflicts with the town's wishes for its future.

Watch for notices of the public hearings and try to take part in the process by reviewing the Draft Plan before the first hearing. To reserve a copy of the Plan, return the coupon in the next column to the Planning Commission, c/o of the Town Office, or call John Riley at 229-5988. Requests must be received by November 5, 1992.

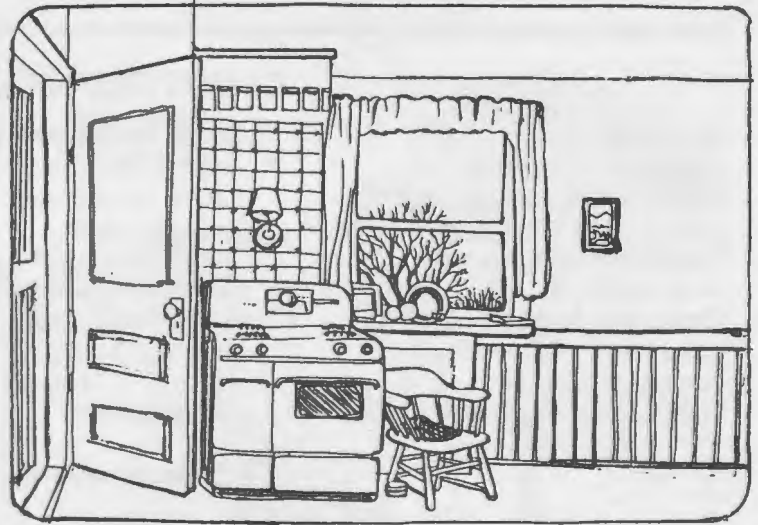

## CHURCH CHIMES

*Old Brick Church  
Old Meeting House*

Two of our long-time members, Eula Brown and Richard Weber, were honored for their community work by the Council on the Aging at its dinner meeting on July 31st.

The Brick Church Club is holding its annual FALL FAIR on Wednesday, November 11, at the OBC Sunday School Building. The coffee hour starts at 9:00 a.m., and sales start at 9:30 a.m.

Everyone in the community is welcome for the Koffee Klatch the first Monday of each month at the Sunday School building. Stop by on November 2 between 9:30 a.m. and 11:00 a.m.

Choir Director June Morse is planning to put the choirs and the children through their paces with a production of *Amahl and the Night Visitors* for the Christmas season. One performance will be part of the Candlelight Service at the Old Meeting House, and three others are also planned.

YES, I would like a copy of the Draft Plan to review.

Please put my name on a copy and I will be sure to stop by the Town Office and pick it up. Thanks!

Name: \_\_\_\_\_

Phone: \_\_\_\_\_

(Please return to the Town Office, East Montpelier, on or before November 5!)

## COMMITTEE MEETING CALENDAR

Selectmen	2nd & 4th Wednesday	7:00	Town Office
Planning Commission	1st, 3rd, 4th Thursday	7:30	"
Zoning Board of Adjustment	2nd & 4th Monday	7:30	"
Conservation Fund Advisory Comm.	2nd Thursday	7:30	"
Volunteer Fire Department	Every Tuesday	7:00	Fire Station, Templeton Rd.
U-32 School Board	2nd & 4th Tuesday	7:30	U-32
Elementary School Board	1st Thursday	7:00	Elementary School
Town Clerk's Office Hours	Monday-Thursday: 9-5, Friday: 9-12		Town Office
Zoning Administrator	Tuesday & Thursday	1:00-2:30,	Town Office
Four Corners Schoolhouse Ass'n.	3rd Wednesday	7:30	Four Corners Schoolhouse

Meeting times are subject to change

## EVENTS CALENDAR

Saturday, October 31	Halloween Party	Four Corners School
Tuesday, November 3, 7 - 7	Election Day: Polls Open	Elementary School
Tuesday, November 10, 9 - 5	Taxes Due	Town Office
Wednesday, November 11, 9:30 - 3:00	Fall Fair	Old Brick Church
Wednesday, November 18	A Taste of Mayan Culture	Elementary School
Wednesday, November 25, 7:30 p.m.	Thanksgiving Eve Service	Old Meeting House
Friday, December 4, 4 - 8	Holiday Fair	Elementary School
Sunday, December 20, 9:30 a.m.	Children's Christmas Pageant	Old Meeting House
Sunday, December 20, 7:30 p.m.	Candlelight Service	Old Meeting House
Thursday, December 24, 7:30 p.m.	Candlelight Service	Old Brick Church

## EAST MONTPELIER SIGNPOST

*Published six times a year; mailed without charge to all residents of East Montpelier.  
Subscriptions mailed out of town for \$10 a year. Business card ads: \$15/issue or \$75/year.*

Jean Cate, Publisher, 223-2951

David Coburn, Copy Editor, 223-6886

Anne Sherman, Business Manager, 223-2693

Cherie Langer, Managing Editor, 229-4858

Janet MacLeod, Artist, 229-4349

Sylvia Tosi, Town Records, 223-3240

Janice Waterman, News Editor, 223-5826

Printed on Recycled Paper with Soybased Ink

*East Montpelier Signpost*  
RFD 1, Box 80  
East Montpelier, Vermont 05651

*Address Correction Requested*  
*Return Postage Guaranteed*

Volume 3, No. 2

### INSIDE:

**BRADFORD LANE**  
**WEC**  
**TOWN PLAN**  
**AUCTION TALLY**  
**OOPS!**  
**VOTE!!**

Bulk Rate  
U.S. Postage  
PAID  
L. Brown and Sons, Inc.

